

FILED
GREENVILLE CO. S.C.
MAY 3 11 36 AM '83
DONNIE S. TANKERSLEY
R.M.C.
-79-

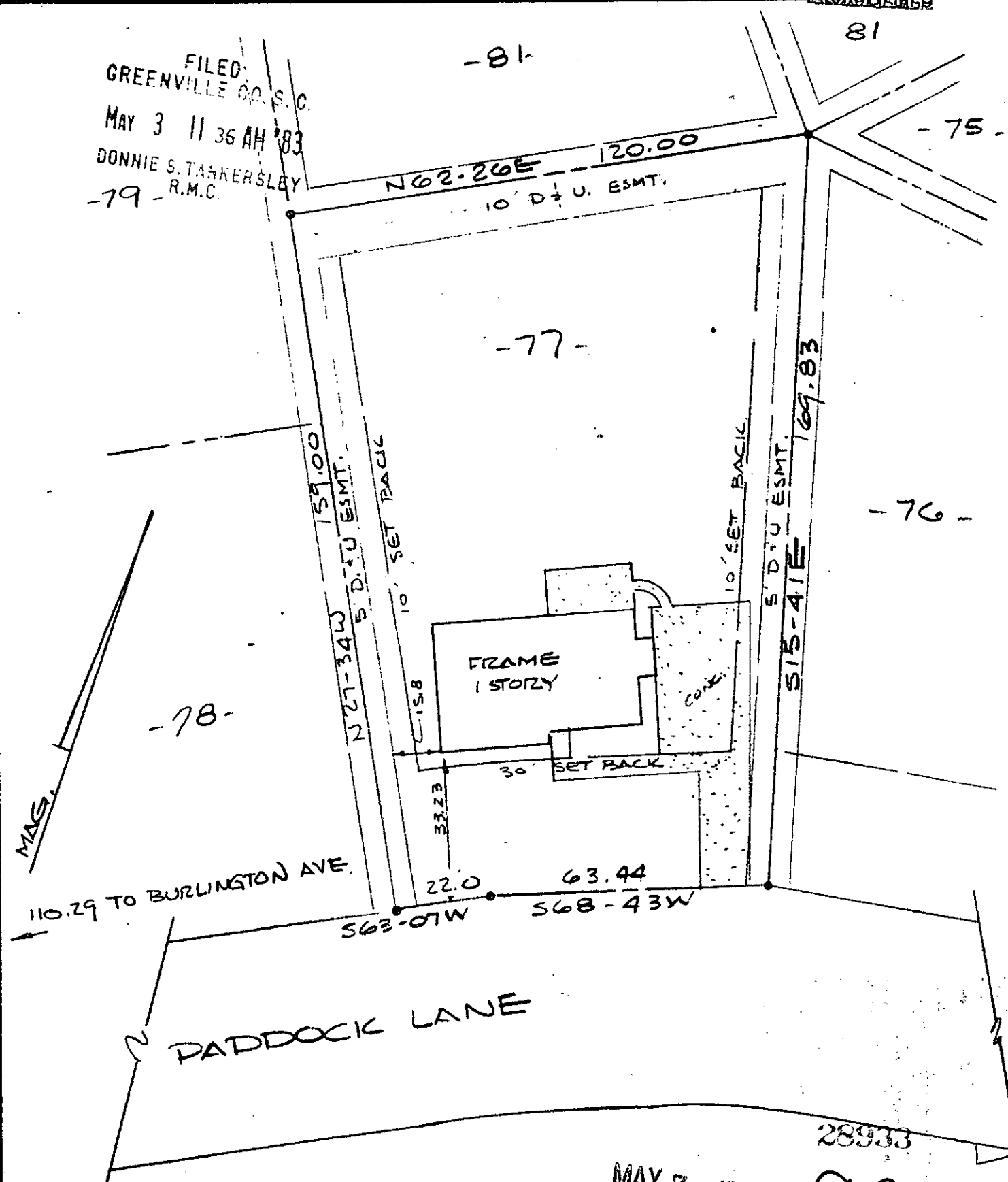

NOTES:

1. THIS DWELLING IS NOT LOCATED IN A FLOOD DISASTER AREA.
2. PROPERTY IS SUBJECT TO ANY AND ALL RIGHTS-OF-WAY AND EASEMENTS OF RECORD.

MAY 3 1983 9-5-27

THIS IS TO CERTIFY THAT ON THE DATE SHOWN HEREON, I DID SURVEY THE ABOVE PROPERTY, THE SAME BEING KNOWN AND DESIGNATED AS LOT NO. 77-SEC. II WESTMINSTER VILLAGE AS SHOWN BY A PLAT RECORDED IN THE CLERK OF COURTS OFFICE FOR GREENVILLE COUNTY IN PLAT BOOK S-P AT PAGE 93 I FURTHER CERTIFY THAT THE PROPERTY LINES, STREETS, AND BUILDINGS ARE AS SHOWN ABOVE AND THAT THERE ARE NO ENCROACHMENTS EXCEPT AS SHOWN.

APR. 21, 1983
DATE

Robert R. Spearman
ROBERT R. SPEARMAN REG. L. S. NO. 3615

TITLE
SURVEY FOR

RONNIE WAYNE &
BRENDA G. WAYNE

STATE SOUTH CAROLINA COUNTY GREENVILLE

SCALE 1" = 30' DATE 4/21/83 REF. NO.

LEGEND

- IRON PIN (OLD)
- IRON PIN (NEW)
- △ NAIL & CAP
- AS NOTED

GRAPHIC SCALE
15 0 30

ROBERT R. SPEARMAN
Registered Surveyor 3615
Post Office Box 6
Easley, South Carolina 29640
PH. 803-859-2309

SEAL

001-2 WY 3 83 1444 3.20CI